

Applies To: **2003 S2000 – ALL**
December 10, 2002

2003 S2000: PDI and New Model Information

This service bulletin tells you what you need to do for PDI of the 2003 S2000. It also describes some of the vehicle's features, equipment, and service information. Here is a list of the topics.

This bulletin includes these PDI procedures:

- Installing Fuses
- Removing the Convertible Top Shipping Cover
- Installing the Antenna Mast
- Checking the Keyless Remote Transmitters
- Removing the Spring Spacers
- Installing the Body Plugs
- Installing the Front and Rear Strakes
- Setting the Digital Clock

This bulletin provides this model information:

- Accumulated Mileage on Odometer
- Fuel Fill Door Release
- Washing the S2000
- Convertible Top Operation
- Starting the Engine
- Shifting Into Reverse
- Dust and Pollen Filter
- Liquid Crystal Display
- Plastic Roll Bar Covers
- Spare Tire
- Tire Rotation
- Wheel Balance and Alignment
- Oils and Filter
- Anti-Theft Radio Identification Card

WARRANTY CLAIM INFORMATION

None; these procedures are considered part of PDI.

PDI PROCEDURES

NOTE: Make sure you download the latest PDI form from ISIS. [From the Interactive Network (iN), click on **Service, Service Publications (ISIS), Search By Publication, Pre-Delivery & New Model Information, PDI Checklist - Cars**, and print out the form.]

Installing Fuses

The No. 54 (30 A) fuse (Backup/ACC) in the main under-hood fuse/relay box is removed during shipping and stored in the beverage holder. Make sure you reinstall this fuse.

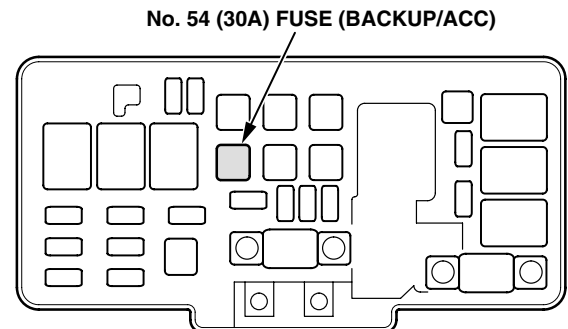

Removing the Convertible Top Shipping Cover

To prevent damage to the convertible top and to the rear window, follow these steps when removing the shipping cover:

1. Rinse the entire vehicle with water.
2. Peel off the tape from the windshield along the front edge of the shipping cover.

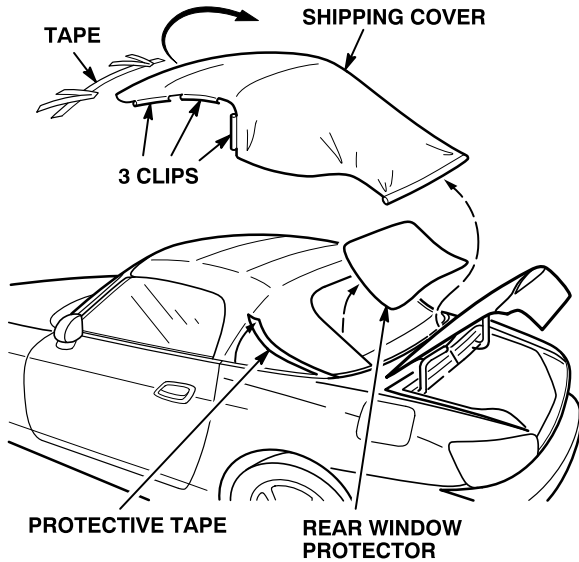

3. Release the three shipping cover clips in each window opening.
4. Pull back the shipping cover over the trunk.
5. Open the trunk, and remove the shipping cover from under the trunk lid.
6. Remove the shipping cover from the vehicle.
7. Remove the rear window protector sheet, and peel off the protective tape.
8. Peel off the Rapgard from the rest of the vehicle.

Installing the Antenna Mast

The antenna mast is shipped in the PDI plastic bag. Make sure the antenna mounting threads are clean, then screw it into the antenna mount in the rear quarter panel.

Checking the Keyless Remote Transmitters

The S2000 has a factory-installed keyless entry system. An optional dealer-installed security system with keyless entry is also available. The remote transmitters for the keyless entry system and security system look similar, but they are not interchangeable.

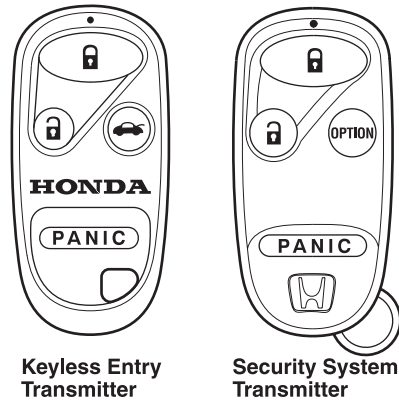

Two remote transmitters for the keyless entry system are stored in the upper console glove box during shipping. Make sure the transmitters lock and unlock both doors and open the trunk. The trunk release has a **2-second** delay.

Removing the Spring Spacers

The S2000 is shipped with rubber spacers on the springs to lift the vehicle and prevent shipping damage. Make sure you remove the spring spacers before driving the vehicle over **12 mph** or the vehicle could get damaged. To remove the spacers, raise the vehicle on a lift to extend the springs. Remove the five spacers from each of the front springs and the two spacers from each of the rear springs.

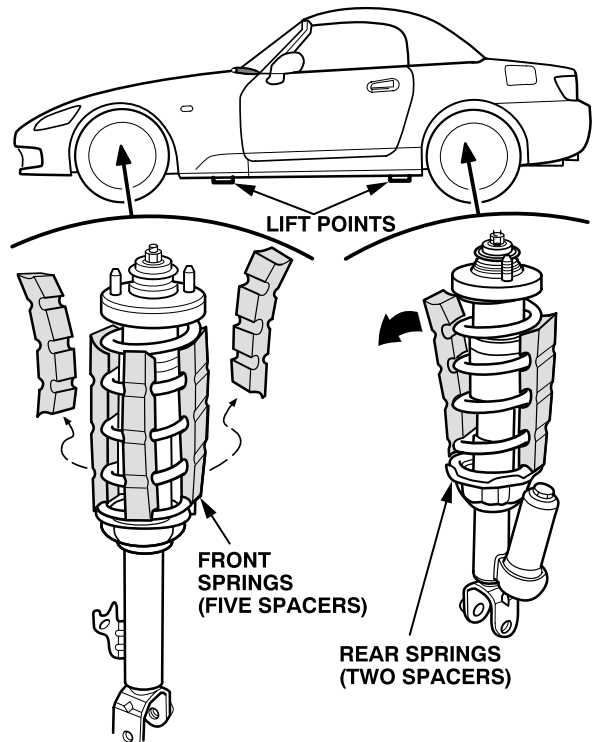

Installing the Body Plugs

Four body plugs are included in the PDI plastic bag. Make sure you install them in the tie-down holes.

The front tie-down holes have two layers. Make sure you install the front plugs on the *inner* layer.

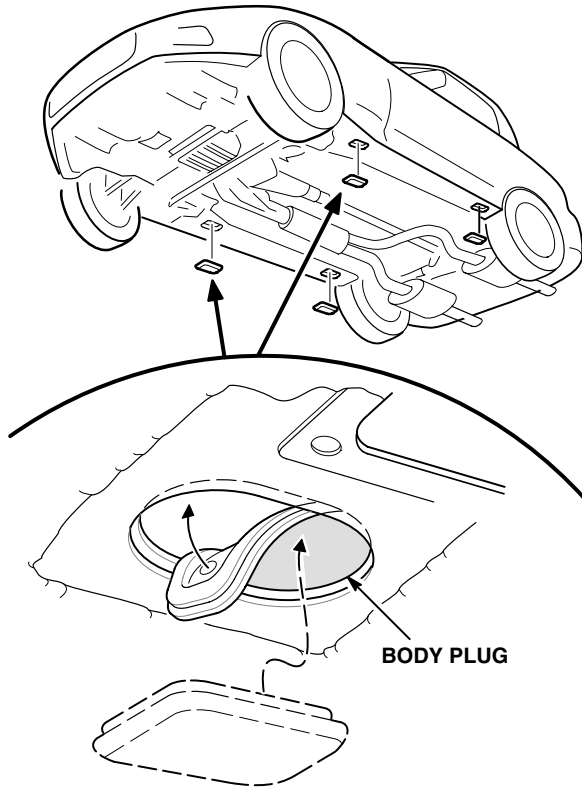

Installing the Front and Rear Strakes

Front and rear strakes and related hardware are included in the PDI plastic bag. Install the front strakes on both sides of the vehicle. Remove the rear wheels, and install both rear strakes.

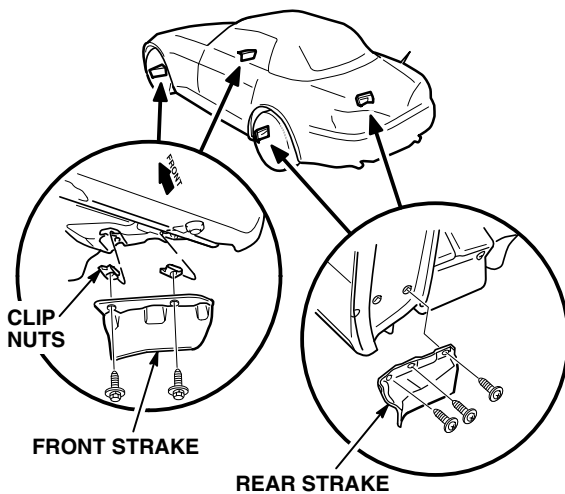

Setting the Digital Clock

To set the time, press and hold the **CLOCK (SCAN RPT)** button, then press the **H** (Preset 4) button to change the hour setting or the **M** (Preset 5) button to change the minute setting.

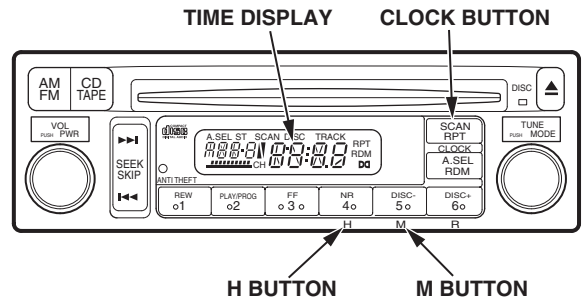

NEW MODEL INFORMATION

Accumulated Mileage on Odometer

Some vehicles may have up to **60 miles** on the odometer at the time of delivery. This is due to factory testing to ensure high-quality vehicle production.

Fuel Fill Door Release

To open the fuel fill door, pull the release knob on the driver's door jamb.

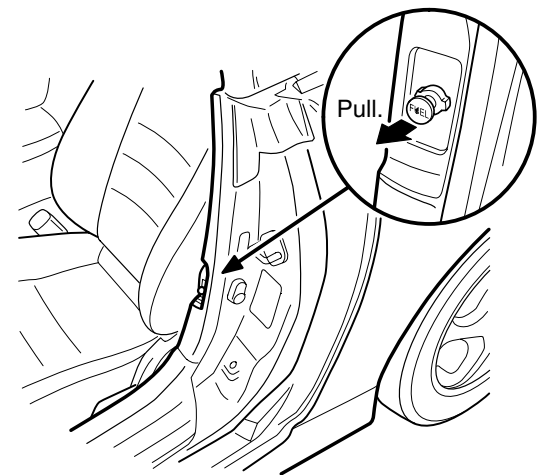

Washing the S2000

Do not use an automatic car wash or high-pressure washer on an S2000. Water may leak into the interior, damage the convertible top, or both.

Convertible Top Operation

To lower the convertible top, do this:

1. Set the parking brake. The convertible top will not work unless the parking brake is fully engaged.
2. Turn the ignition switch to ON (II).
3. Push in the tabs on the two lock handles, and pull the handles down.

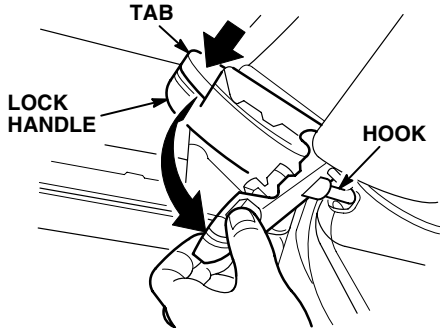

4. Push the convertible top forward while you release the hooks from the windshield header.

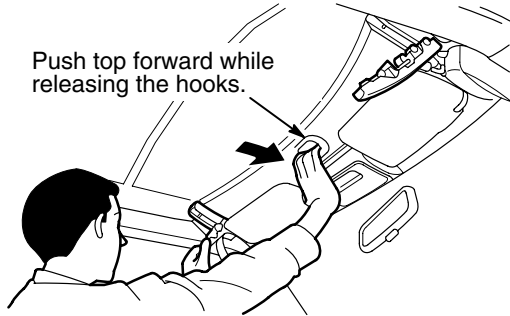

5. With the hooks released, push the lock handles up until they latch.

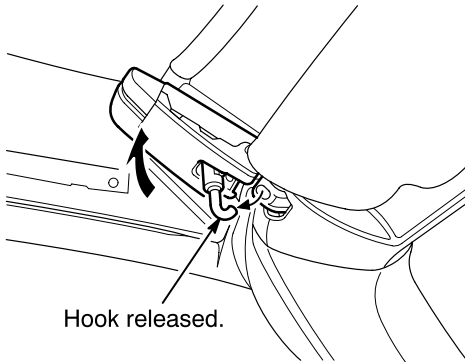

6. Pull back and hold the **ROOF** switch. Both windows start to lower and the convertible top folds back. Make sure the top goes all the way down.

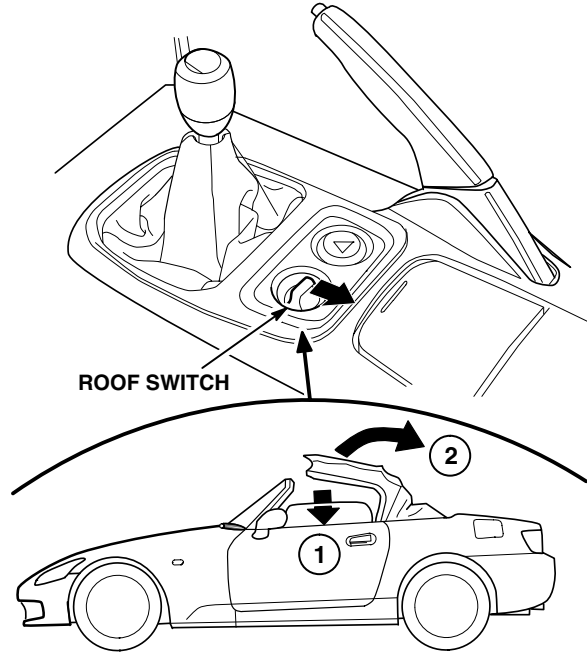

To raise the convertible top, do this:

1. Set the parking brake. The convertible top will not work unless the parking brake is fully engaged.
2. Turn the ignition switch to ON (II).
3. Push the **ROOF** switch forward and hold it. If the windows are raised, both windows start to lower, and the convertible top rises. Release the **ROOF** switch when the top reaches the windshield header.
4. Push in the tabs on the lock handles, and pull the handles down.
5. Push the tabs again to set the hooks into the windshield header. Because of the weight of the glass rear window, make sure you pull the roof all the way forward so the hooks can set.
6. Push the lock handles up until they latch.

Starting the Engine

Press the clutch pedal all the way down. Turn the ignition switch to ON (II). Press the **ENGINE START** button.

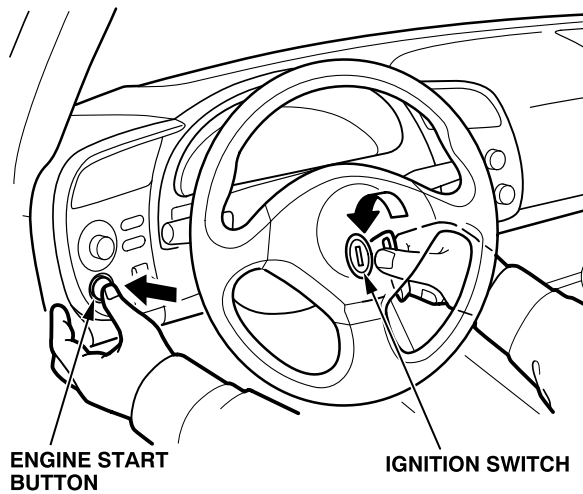

Shifting Into Reverse

The 6-speed manual transmission has a lockout feature so you cannot accidentally shift from 5th gear to Reverse instead of to 6th gear. Press the clutch pedal all the way down, move the shift lever to the Reverse side of the Neutral gate, then push the shift lever down, and shift into Reverse.

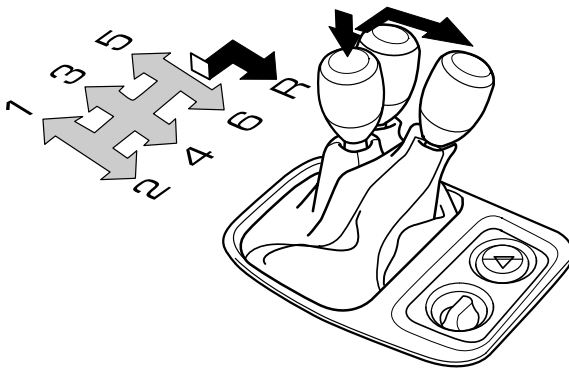

Dust and Pollen Filter

The dust and pollen filter is under the right side of the cowl. To replace the filter, release the clips, and lift up the right side of the cowl.

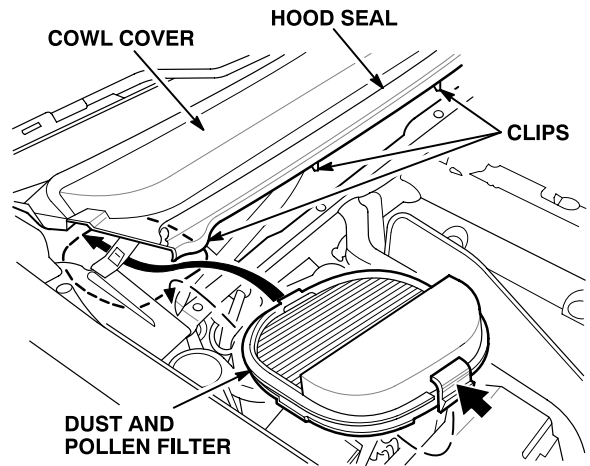

Liquid Crystal Display

The - and + buttons on the left side of the instrument panel let you control the panel brightness. Push the buttons to make sure there are five levels of brightness.

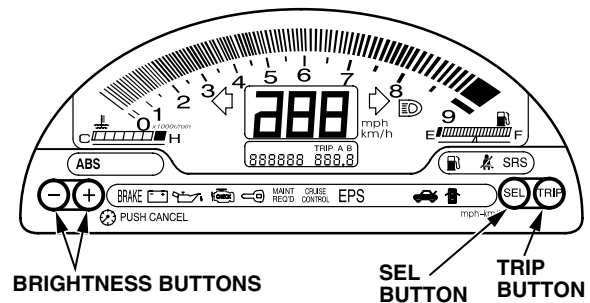

To switch the reading between miles per hour and kilometers per hour, push the **SEL** button on the right side of the instrument panel, and hold it until you hear a beep.

To switch between Trip A and Trip B, push and release the **TRIP** button. To reset a trip meter, display it, then push and hold the **TRIP** button until you hear a beep and the number resets to **0.0**.

The tachometer does not work properly when the interior temperature is **-10° F** or lower.

Plastic Roll Bar Covers

The integrated roll bar behind each seat has a plastic cover. Do not try to remove it; you would destroy the cover if you do. If you need to remove the plastic roll bar covers, unbolt the entire roll bar assembly from the body.

Spare Tire

Do not drive the S2000 with the compact spare tire mounted on the rear; it would damage the limited slip differential. Refer to the owner's manual for proper spare tire use.

Tire Rotation

Do not rotate the tires on an S2000; the rear tires are wider than the front tires and would not fit correctly. Since the tires are directional, you also cannot rotate them side-to-side.

Wheel Balance and Alignment

The wheels on an S2000 have no exterior flange to mount wheel weights or alignment equipment. You can, however, mount Honda alloy wheel weights on the inner side of the wheels; but they must be self-adhesive weights. See page 1-14 of the 2000–03 S2000 Service Manual. Mount alignment equipment on the outer lip of the wheels.

Oils and Filter

Engine Oil: SAE viscosity 10W-30 or 5W-40 (cold weather).

Transmission Oil: Honda MTF.

Differential Oil: API GL5 gear oil, SAE 80-90 or 75-90.

Because of the high-revving nature of the S2000 engine, the oil filter torque is very important. Make sure you torque the filter to **22 N·m (16 lb-ft)**.

The engine oil dipstick has a black handle. The dipstick is on the left side of the valve cover.

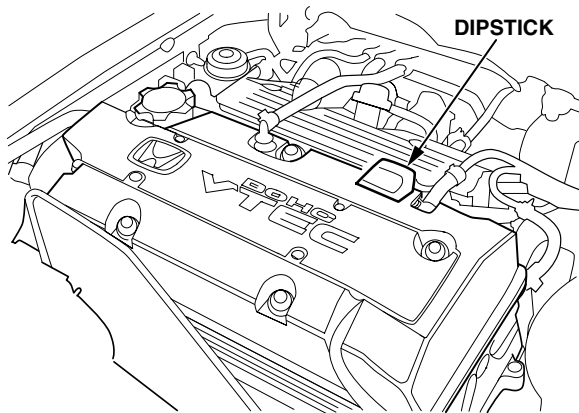

Anti-Theft Radio Identification Card

A card listing the audio system's five-digit anti-theft code and its eight-digit serial number is stored in the large well under the upper cover of the rear console. Make sure you locate this card during PDI.



If this card is missing, and the audio system was disconnected from electrical power, you need to get the five-digit anti-theft code from the Interactive Network (iN) and enter it into the system to make it work. To do this, you first need to get the audio system's serial number using these steps:

1. Turn the ignition switch to ON (II) and turn on the radio. Make sure the display reads **CoDe**.
2. Turn off the radio.
3. Press and hold the **1** and **6** radio preset buttons, then turn on the radio. The radio will display a **U** and four digits (for example, **U1004**); these are the first four digits of the serial number. Then the radio will display an **L** and four digits (for example, **L8564**); these are the last four digits of the serial number. Record all eight digits, then go to step 4.
4. Get the five-digit anti-theft code from the Anti-Theft Code Inquiry display in the iN. (From the iN, click on **Service, Accessories, Anti-Theft Code Inq.** Enter the eight-digit serial number.)
5. Enter the anti-theft code into the radio.